

- 1 Tile movement joints with PVC infill
- 2 Highly durable
- 3 Easy to install

Standard version	Height h [mm]	Visible Width vw [mm]	Standard Length l [meter]
MTFWA-8	8	10	2.7
MTFWA-10	10	10	2.7
MTFWA-12.5	12.5	10	2.7

### Material Options

- Extruded Aluminum

### Finish Options

- Colored anodized
- Powder coat

### F Shape

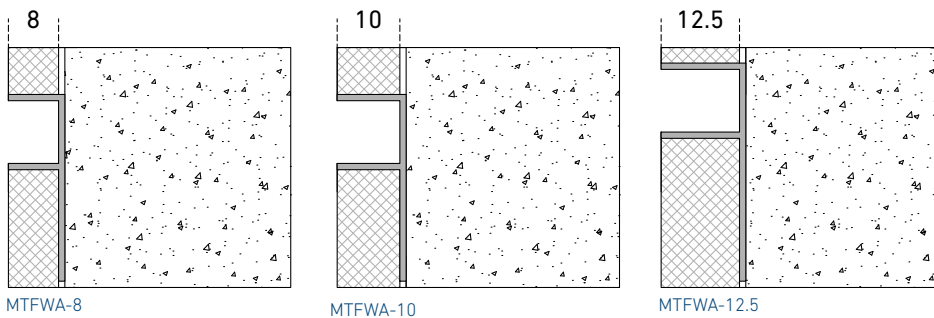

### Standard color range



Actual finish might vary from the illustration. If required, colour sample will be provided for approval.